

# Paasche®

INSTRUCTIONS AND PARTS LIST VLSTPRO-8/31/2011  
Supersedes Instructions & Parts List VLSTPRO-5/3/2011

## VLSTPRO - CLASSIC

Siphon Feed - Internal Mix -  
Double Action Airbrush

**WARNING:** Spray materials may be harmful if inhaled or allowed to come into contact with the skin or eyes. Consult the product label and Material Safety Data Sheet supplied for the spray material. Follow all safety precautions.  
**CAUTION:** Well Ventilated Area Required to remove fumes, dust or overspray. Secure airhose to Airbrush with V-62 Wrench for safety and to prevent air leaks.  
**Maximum Air Pressure 75 P.S.I.**



### INTRODUCTION:

With modifications we learned from the professional artists that use the VL, we created the ultimate painting machine! The **VLSTPRO** is a significant upgrade to the classic 'VL' with features that airbrushers of all levels will appreciate. The new head lets you clean any accumulation of paint off the tip and needle with a quick pinch of the fingers. The trigger guide has been lengthened for increased paint flow at maximum draw, and the cut-away handle allows quick pullback to blow out clogs. A threaded bottle connector locks onto the bottle stem for worry free one-handed painting and the bottle will not fall off once fastened properly. And inside, it's still the same great 'VL' that professionals have trusted for decades. Available in size #3 off the shelf with size #1 and #5 components available for your assembly. **PTFE Packings.**

### Head Sizes - Patterns - Fluid Thickness

- Size 1** - Tip size .022 inches or .55mm  
- Used for fine detail. Pencil Line to 1" patterns  
- Paint must be thinned further than 3 & 5 heads
- Size 3** - Tip size .029 inches or .73mm  
- Less detail than the size 1 head. 1/32" to 1-1/2" patterns  
- Can spray slightly thicker paint than size 1 head
- Size 5** - Tip Size .042 inches or 1.06mm  
- Less detail than the size 3 head. 1/16" to 2" patterns  
- Can spray slightly thicker paint than size 3 head

### Working Pressures:

- Operating pressures 20-55 PSI; Maximum pressure 75 PSI
- 20-30 PSI is best for detail spraying w/ properly thinned materials
- Use the higher pressures for thicker material where fine detail is not critical or thin the paint to allow lower pressures.

### Equipment Set-up:

The Airbrush is held in the same manner as a pen, with the index finger comfortably over the Trigger.

1. Attach airhose to air supply and to airbrush. If using a regulator, set pressure between 20 -30 PSI.
2. Attach the color cup or bottle assembly to color socket and then tighten lock nut to bottle with wrench.

### Airbrush Operation:

1. Press down on Trigger to release air and pull back on Trigger to control quantity of color.
2. To spray a fine line without heavy ends, start moving the airbrush without release of color. Then start the color at the beginning of line and stop the color at the end, but continue the motion of the airbrush after the color has stopped.
3. Practice this movement until you can spray a fine line or a broad pattern without heavy buildup at the beginning or end of your strokes.
4. Speed of movement controls density of color and fading effects at beginning and end of strokes.
5. For detail hold the airbrush close to the surface, push down for air and slowly pull back on the Trigger to release a small amount of paint.
6. For background work and broad effects, hold the airbrush away from the work surface and pull back on Trigger to release required amount of color.
7. For stippling remove the aircap, push down on the Trigger and pump the Trigger forward and back. Adjust the air pressure between 15 and 50 PSI for desired stipple effect.
8. For more instruction see the "22 Airbrush Lessons for Beginners" booklet enclosed with your airbrush.

**Paasche Airbrush Company**  
4311 North Normandy Avenue  
Chicago, IL 60634-1395

**Phone:** 773-867-9191 • **Fax:** 773-867-9198  
**Website:** [www.paascheairbrush.com](http://www.paascheairbrush.com)  
**E-Mail:** [info@paascheairbrush.com](mailto:info@paascheairbrush.com)

Printed in the U.S.A.

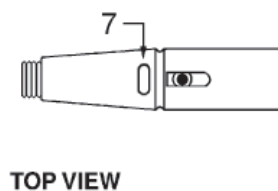
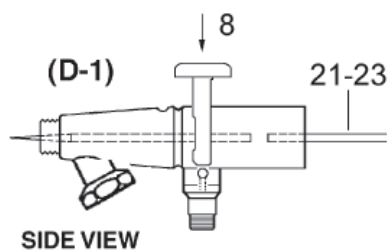
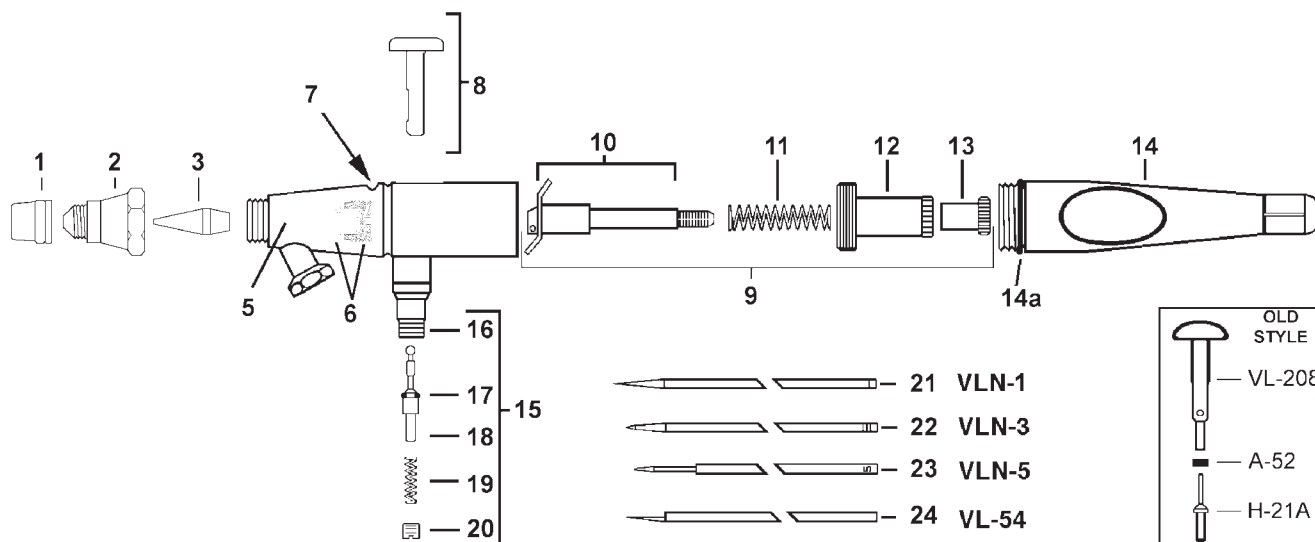

**VLSTPRO AIRBRUSH PARTS**

NO.	PART NO.	DESCRIPTION	NO.	PART NO.	DESCRIPTION
1.	XI-41	Needle Protecting Cap	14.	VL-134C	Cut-Away Handle (w/ 'O' Ring VL-224)
2.	VLH-1, 3 or 5	Head (Sizes 1 & 5 Optional)	15.	VL-215	Air Valve Assembly
3.	VLT-1, 3 or 5	Tip (Sizes 1 & 5 Optional)	16.	VL-20	Valve Casing
5.	VLS-163	'VLS' Shell Assembly w/ VL-20	18.	VL-214	Valve Plunger (with A-53)
6.	MU-612	PTFE Packing & Packing Nut (sold as set)	19.	A-22	Valve Spring
7.	VL-175	Line Adjustment Assembly	20.	A-23R	Air Valve Nut
8.	VL-213	Trigger	21-23.	VLN-1, 3 or 5	Needle (Sizes 1 & 5 Optional)
9.	VL-186	Needle Valve Assembly	<b>Optional Items:</b>		
10.	VL-191A	Rocker Assembly	17.	A-53	Valve 'O' Ring (Pack of 6)
11.	VL-140	Spring	24.	VL-54	Reamer (Optional)
12.	VL-136A	Needle Adjusting Sleeve	14a.	VL-224	'O' Ring for VL-134C
13.	VL-141	Locknut	VL-227-1, 3 or 5	Multiplehead (Specity Size)	
			VLH-1, 3 or 5	Head	
			VLT-1, 3 or 5	TIP	
			VLN-1, 3 or 5	Needle	

**REMOVING/REPLACING THE NEEDLE AND HANDLE (Illustration page 2):**

1. Unscrew the handle and loosen Locknut #13 by turning counterclockwise. Depress the Trigger #8 and hold in Down position while removing or inserting the needle. This assures the needle moves freely through the trigger. Gently remove the needle, rotating if necessary, Do NOT force out!
2. A loose needle can cause sputtering if there is any air leakage around the needle and Packing & Nut Assembly #6. If there is no noticeable drag on the needle by the packing, then tighten the Nut of the Packing & Nut Assembly #6.
3. Inspect the condition of the needle. If it is bent or misshapen in any way, replace it with a new needle. A bent needle can damage or split the Tip #3 causing bubbles or a rough spray pattern.
4. Hold trigger in DOWN position, insert the new needle into the Rocker Assembly #9. Gently push needle through, rotating if necessary, until the needle stops in the front of the tip.
5. Release trigger and tighten locknut by turning clockwise.

**REPLACING TRIGGER (Illustration D-1, page 2):**

If the Trigger #8 is removed, it must be replaced inside the airbrush shell before the Rocker Assembly #9 and needle are re-inserted.

1. Hold trigger so the opening in the lever is in-line with the opening in the end of the airbrush shell and the smooth side of the trigger stem is to the rear. (see D-1).
2. Insert trigger so the bottom of the stem covers the round top of the valve plunger.
3. Once the trigger has been inserted into the slot on the top of the shell, you will be able to press down on the trigger and it will return to the up position when released. Proceed to replace rocker assembly and balance of parts as above. The needle when inserted will prevent the removal of the trigger.

**REPLACING THE TIP:**

1. Remove handle, loosen Locknut #13 and withdraw needle about one inch (1").
2. Un-screw the Head #2 and remove. The Tip #3 can now be easily removed by hand. If stuck in shell tap lightly with wrench.
3. Place new tip into position and tighten head to shell with wrench. Push needle forward until it seats fully forward in tip and tighten locknut.

**ADJUSTING OR REPLACING WORN PACKING WASHER:**

1. If PTFE Packing #6 becomes worn or loose it must be tightened or replaced.
2. You will need a small screwdriver to remove or tighten the Packing Nut #6.
3. When replacing your PTFE Packing press packing onto the Packing Nut #6. Use a small screwdriver to tighten packing nut into shell until it is tight then back out one-half turn, may vary.
4. Now insert needle - you should feel a slight resistance. If too loose or too tight adjust the packing nut with screwdriver until you feel some slight resistance.
5. Now completely re-assemble guts of airbrush.

**CLEANING THE AIRBRUSH:**

1. Paint passes from the bottle connection forward so the trigger area back will most likely not need cleaning.
2. You can back flush the paint into your bottle by covering the Needle Protector with your finger and then pressing down on the trigger and pulling slightly back. This forces paint from the fluid passage back into the bottle. **Never use an open cup for back flushing.**
3. In between color changes or before storing the airbrush attach bottle with appropriate cleaner and spray into sink until it runs clear.
4. Remove needle and wipe clean then replace.
5. If paint has dried for a time you can remove the front tip and head for soaking or soak just the front of the airbrush in cleaner.
6. Use cleaner for the material you are spraying. Keep Trigger area dry if soaking.

**PERSONAL SETTINGS:**

- Needle Adjustment Sleeve- Used to increase or decrease spring tension for the Trigger pull back. Thread into the shell until the trigger stroke feels comfortable. Threading in until it stops can cause the trigger to jam.
- Line Adjustment Assembly- Used to preset paint flow. When rotated clockwise the trigger will retract opening the fluid passage. This allows a set paint flow when only pushing down on the trigger.

**TROUBLESHOOTING:**

Bubbling in cup

1. VLH Head #2 needs to be wrench tightened

Skipping or spitting:

- |                                |   |
|--------------------------------|---|
| 1. Paint too thick             | -Reduce with thinner  |
| 2. Tip not seated              | -Tighten VLH Head with wrench   |
| 3. Tip split or damaged Needle | -Replace tip or needle  |
| 4. Needle or tip dirty         | -Clean and replace  |
| 5. Air pressure too low        | -Increase pressure or thin paint further (need 20 or more PSI to spray most paints) |

Airbrush Not Spraying:

- |                             |   |
|-----------------------------|---|
| 1. Clogged tip              | -Remove tip and clean   |
| 2. Needle not moving        | -Tighten needle locknut                                       |
| 3. Loose VLH Head           | -Wrench tighten   |
| 4. Low air pressure         | -Increase pressure (need 20 or more PSI to spray most paints) |
| 5. Bottle vent hole plugged | -Use needle or pin to clear air hole                          |

Sprays double line or heavy to one side:

- |                             |   |
|-----------------------------|---|
| 1. Split tip or bent needle | - Replace   |
| 2. Dirty tip or needle      | - Remove and clean  |
| 3. Tip not centered in Head | - Remove head and clean airbrush seat and tip seat then reassemble. Use wrench for head |

Jammed trigger or poor trigger motion:

- |                                  |   |
|----------------------------------|---|
| 1. Adjust Needle Adj. Sleeve     | - Screw or unscrew the sleeve to lessen or increase tension on trigger motion |
| 2. Paint leaking to trigger area | - Remove guts of airbrush and slightly tighten packing or replace if needed   |
| 3. Lubricate needle and trigger  | - Apply lubricant to needle shaft and Trigger slot area                       |

**ACCESSORIES**

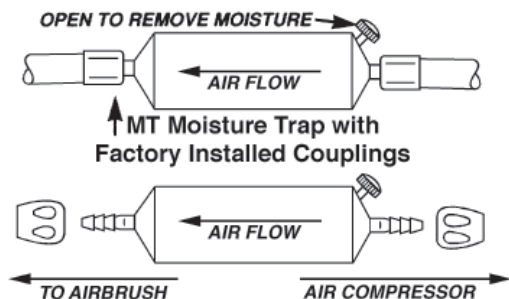
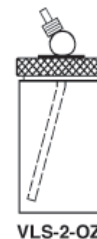

Do-It-Yourself Installation: The Moisture Trap is designed for use with all Airbrushes to remove water from the airline. To install-cut the airhose about 18" from the Airbrush coupling and insert as illustrated.

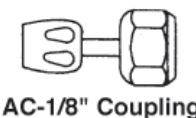
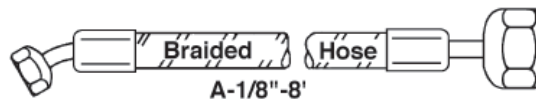
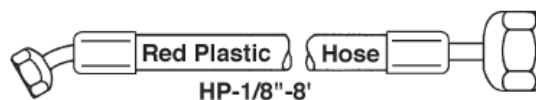

**VLSTPRO BOTTLE ASSEMBLIES & CUP**

- VL-1/4-OZ** Metal Color Cup (7cc)
- VLS-1-OZ** Color Bottle Assembly (29cc)
  - VLS1** 1 oz. Cover Assembly
  - H-99** 1 oz. Glass Bottle (29cc)
- VLS-3-OZ** 3 oz. Bottle Assembly (89cc)
  - VLS3** 3 oz. Metal Cover Assembly
  - H-108** 3 oz. Glass Bottle (89cc)
- PCVLS-3-OZ** 3 oz. Plastic Cover & Metal Tube Assem. (89cc)
  - PCVLS3** 3 oz. Plastic Cover & Metal Tube Assem.
  - H-108** 3 oz. Glass Bottle (89cc)
- VLPS-3-OZ** 3 oz. Plastic Bottle Assembly (89cc)
  - VLPS3** 3 oz. Plastic Cover & Tube Assembly
  - 62-17P** 3 oz. Plastic Bottle (89cc)
- VLS-2-OZ** Aluminum Cup Assembly (60cc)
  - VF-23** 2 oz. Aluminum Cup (60cc)

**NOTE:**  
**3-JG** Gasket for 3oz and 2oz bottles  
**5-G** Gasket for 1 oz bottles

**Recommended Compressors & Accessories**



**D500 AIR COMPRESSOR (1/8 H.P.) (ETL Listed)**  
 Economical and suitable for all airbrushes spraying properly thinned fluids. It is capable of delivering up to 35 P.S.I. operating pressure depending on airbrush being used. The Paasche **D500** is an oilless piston compressor. It operates on 110-120 Volt, 1 phase, 60Hz, and delivers .4 C.F.M. @ 20 P.S.I.  
**Shipping Weight: 8 lbs. (3.6kg)**



**D220R AIR COMPRESSOR (1/6 H.P.), with Switch & R-75 Regulator**  
 Economical and suitable for all airbrushes spraying properly thinned fluids. It is capable of delivering 30 - 45 P.S.I. operating pressure depending on airbrush being used. The Paasche **D220R** is an oilless diaphragm unit and comes with the **R-75 Regulator/Filter** with gauge. It operates on 110-120 Volt, 1 phase, 60Hz, and delivers .7 C.F.M. @ 20 P.S.I.  
**Shipping Weight: 11 lbs. (5kg)**



**DA300R AIR COMPRESSOR (1/6 HP) with Switch CSA approved & R-75 Regulator**  
 1/8 H.P. Piston Compressor with Auto shutoff. Compressor shuts off when airbrush is not in use. Operating pressure is 20 - 30 P.S.I. depending on airbrush being used, delivers up to 35 psi. 120 VAC, 1 Ph, 60 Hz, 1.4 A, 20L/Min. (0.7CFM), Noise 53dB, 1720 rpm.  
**Shipping Weight: 9.14 lbs. (4.6 kgs)**

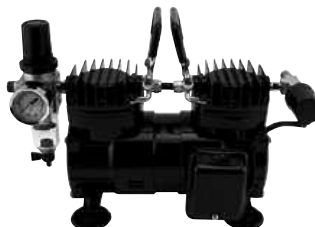

**DA400R AIR COMPRESSOR (1/6 H.P.)**  
 1/6 H.P. Piston Compressor with Auto shutoff. Compressor shuts off when airbrush is not in use. Operating pressure 30 - 50 PSI depending on airbrush being used, delivers up to 55 psi. 110-120VAC, 1 Ph, 60 Hz, 42L/Min. (1.48CFM), 1720 rpm. With **R-75 Regulator & Moisture Trap** included.  
**Shipping Weight: 12.2 lbs. (5.6 kgs)**